

# CONCISE BEAM

Precast Concrete Beam  
Design Software for  
Windows

Design to CSA A23.3,  
ACI 318 & AS3600  
Standards

Available Since 1992

Now Supports  
CSA A23.3-04  
and  
CAN/CSA S6-00

**BLACK MINT  
SOFTWARE**

Black Mint Software  
675 Cooper St.,  
Ottawa, Ontario  
Canada K1R 5J3

[www.BlackMint.com](http://www.BlackMint.com)

## Program Features

- Prestressed, partial-prestressed, or conventionally reinforced concrete, simply supported precast beams with cantilevers.
- Composite slab or topping (optionally reinforced).
- Combine rebar and prestressing strand.
- CSA A23.3, S6 (no moving loads), ACI 318, AS3600 design codes.
- Customize many parameters of each design code.
- Debonded strands, hooked and coated rebar.
- Versatile selection of load types.
- All load cases and combinations required by codes.
- Customizable libraries of sections and materials.
- Use standard cross-sections or any user-defined section.
- Variable cross-section along the beam.
- Strain-compatible section analysis, including strand or rebar slip detection.
- Crack control check and crack width estimate.
- Bilinear deflection analysis.
- Torsion loading and analysis.
- Interface shear check and design (sectional and maximum moment).
- Work in SI metric or Imperial (English) units (switch back and forth at will).
- Optional shored construction.
- Online context-sensitive manual with tutorials.
- Very competitive pricing and high value.
- Regular program improvements.
- Very responsive technical support by engineer/developer.

Learning More About  
Concise Beam at  
[www.BlackMint.com](http://www.BlackMint.com)

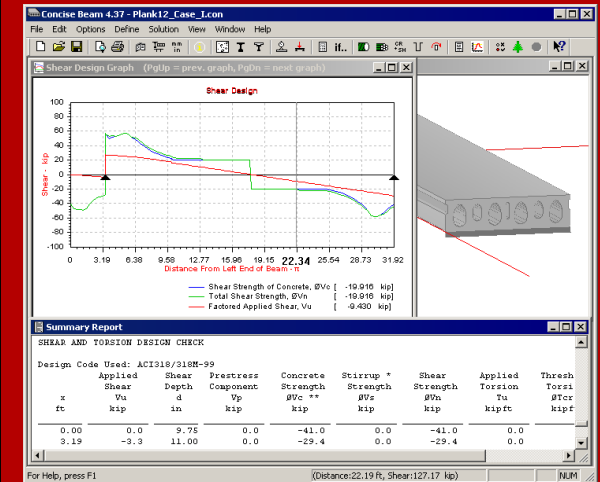

The main window showing results in  
graphical and tabular (text) form

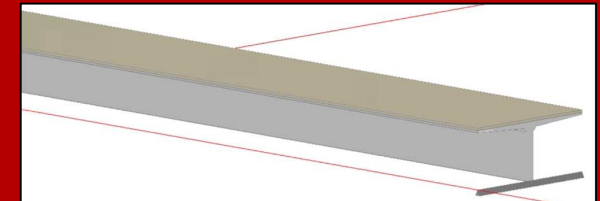
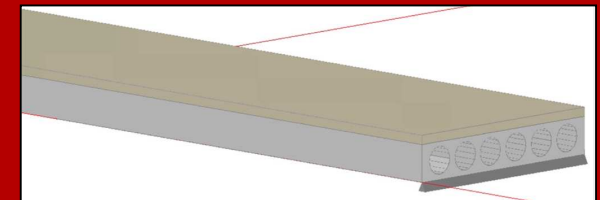
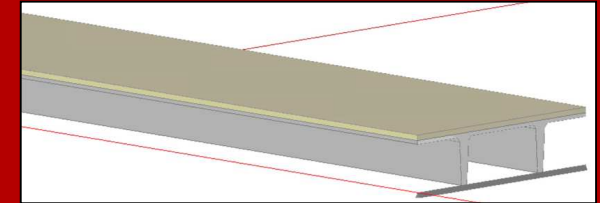

Available Discounts

Discounts of 50% to 75% available for  
multi-user licenses.

## To Obtain a Free Fully-Functional Evaluation

- Download and install Concise Beam today from [www.BlackMint.com](http://www.BlackMint.com). You will be able to evaluate Concise Beam for 30 days with full functionality.
- To continue to use Concise Beam after 30 days you will need to purchase a license and obtain a license key from Black Mint Software.
- Pricing and on-line order forms are available at [www.BlackMint.com](http://www.BlackMint.com).
- Download and use all updates within the period of your license. Concise Beam will not time out.

## How to Contact Black Mint Software

Web:

[www.BlackMint.com](http://www.BlackMint.com)

Email:

[info@BlackMint.com](mailto:info@BlackMint.com)

or contact Dave Marshall, P.Eng. at  
(613) 230-3001

**BLACK MINT  
SOFTWARE**



## Partial List of Users

Delta Corporation, Australia  
Hollow Core Concrete, Australia  
Structural Concrete Ind., Australia  
Westkon Precast, Australia  
Rescrete Industries, Australia  
Sinclair Knight Merz, Australia  
Tindall Corporation, USA  
Walker Parking Consultants, USA  
Old Castle Precast, USA  
Spancrete Industries, USA  
Eagle Precast, USA  
Coreslab Structures Atlanta, USA  
Hanson Spancrete Midwest, USA  
Molin Concrete Products, USA  
Midstates Concrete Products, USA  
Ericksen Roed & Associates, USA  
CSA Group, USA  
Blue Ridge Design, USA  
D.A. Sheppard Consulting, USA  
Iowa Prestressed Concrete, USA  
Fabcon, USA  
Central Pre-Mix Prestress, USA  
Raths, Raths & Johnson, USA  
Hatch Mott MacDonald, USA  
Con-Force Structures, Canada  
Lafarge Canada, Canada  
Strescon Limited, Canada  
Coreslab Structures, Canada  
Pre-Con, Canada  
Prestressed Systems Inc., Canada  
Stubbe's Precast, Canada  
Hyprescon, Canada  
Kluchert & Associates, Canada  
Kassian Dyck & Associates, Canada  
Granite Prestressed Concrete, Canada  
Predecon, Mexico  
Valerio Estructuras, Mexico  
Precreto, Ecuador  
Armada del Ecuador, Ecuador  
Premo Engenharia Ind., Brazil  
GTP, Brazil  
AlRashid-Abetong Company, Saudi Arabia  
Gulf Precast Concrete, UAE  
Square General Contracting, UAE  
High Slant Contracting & Trad. Co., Kuwait  
Ingenierie Structurala S.R.L., Romania

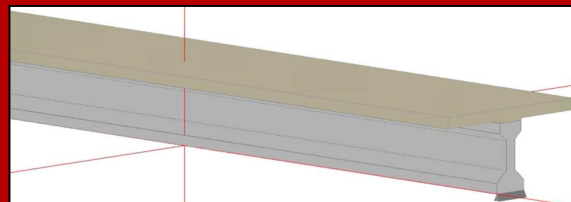

## Partial List of Educational Users

Unitec Inst. of Technology, New Zealand  
Queen's University, Canada  
Royal Military College, Canada  
Memorial University, Canada  
Concordia University, Canada  
University of Windsor, Canada  
Lakehead University, Canada  
Université de Moncton, Canada  
Penn State University, USA  
Washington University, USA  
Pontificia Universidade Católica, Brazil  
Fauldad de Ingenieria, Uruguay  
Universidad Privada Boliviana, Bolivia  
Rangsit University, Thailand  
K. Sutcu Imam University, Turkey

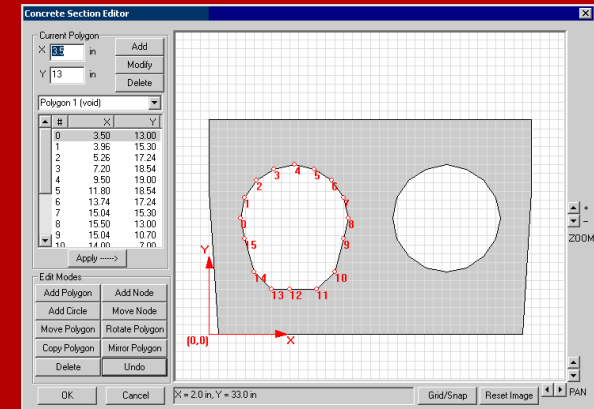

The section editor allows you to model any cross-section

## System Requirements

- A computer capable of running Microsoft Windows 98 or later.
- A configured Windows printer.
- Internet and email access to obtain software, licenses, and notices.